

## Product Information

The Classic STREAM is a fully featured streaming music player that utilises the renowned BluOS operating system and BluOS controller via iOS, Android, Kindle, Mac or PC computers. It allows music playback from all the major audio streaming services such as Tidal, Qobuz, Deezer, Spotify and dozens of others as well as Roon (pending), Airplay2 and MQA decoding.

The objective was to create a significant step up in performance by using everything that we learnt when developing the fantastic XR Series, but retaining the familiar design of the Classic Series, which has resulted in sound quality that will help the Classic Series retain a loyal fan base for years to come.

## Features and benefits

### BluOS streaming

Harnessing the power of BluOS, an advanced multi-room audio software that allows you to stream lossless music to every room in the house, users can locate music anywhere on a home network, cloud music service, or Internet radio station, and share it with any BluOS enabled device.

### PSX-R2 port

The Classic STREAM includes a port for the PSX-R2 power supply. Power from the PSX-R2 is routed internally to the analogue stages to provide a more stable, low-noise power supply for the post-DAC stages of the D/A converter.

### Roon Ready

Roon brings all your music together, so you don't have to worry about where it's stored, what format it's in, or where you stream it from. Roon supports music files stored on internal and external hard drives and NAS, your iTunes library, live radio stations and streamed content from Tidal and Qobuz.

### Airplay2

With Airplay2 on the Classic STREAM, you can connect multiple players around the house and have them communicate with each other through AirPlay. Listen to your music in perfect sync as you walk room-to-room, or play different songs in different rooms, and control everything on your iOS device. You can even say the song you want to listen to and where and let Siri take control of your music experience.

### MQA decoding

Built into the Classic STREAM is a revolutionary end-to-end (studio-speaker) technology known as Master Quality Authenticated (MQA), which captures and delivers master quality audio from your favourite artists' recording sessions to any room in your home. The Classic STREAM includes a powerful decoder and audio renderer for the MQA system, allowing you to hear exactly what the artist recorded and approved in the studio.

### Low power standby consumption

The Classic STREAM features a low consumption standby mode for sustainable operation.

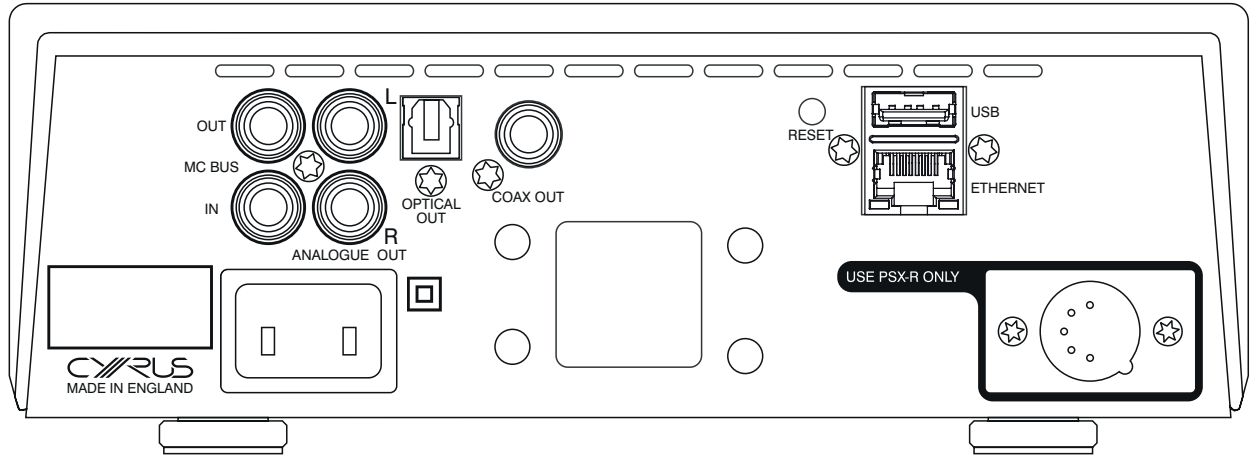

All Cyrus components are housed within our iconic half width die-cast aluminium chassis, which has now been in use for over 30 years across our entire range of Classic & XR products. Designed and built to last the test of time, every single chassis is hand finished using a process called linishing, resulting in every product we build being of the highest quality. As we all continue to be socially responsible, our use of the same chassis design has allowed us to upgrade our customers' products to the very latest components all within the original chassis, saving these old products from going to landfill and our customers making considerable savings too. We estimate that more than 80% of manufactured products remain in use today, making Cyrus one of the most effective users of materials in our industry by far.

## Specifications

Streaming Music Player, SNR-108dB, THD+N 0.0035%	Size (H x W x D) 75 x 215 x 355 mm (2.95" x 8.46" x 13.98")
ESS ES9038Q2M 32 bit QXR tuned DAC	Weight 3.0kg (7lbs)
Line level analogue outputs	EAN 5060020434594
Optical and coaxial outputs	
RJ-45 Ethernet (GigE 1Gbps), Wi-Fi 5(802.11ac, 2.4/5Ghz)	
MC-BUS Connection (control integration with Cyrus system)	
PSX-R2 upgrade port	
Supported audio formats: MP3, AAC, WMA, WMA-L, OGG, ALAC, OPUS, FLAC, MQA, WAV, AIFF, MPEG-4 SLS, up to 192kHz 24 bit	

# BLUOS™



Airplay2 is a trademark of Apple Inc., registered in the U.S. and other countries and regions.